

How to restore the factory settings of WIN10 system

- 1、 Enter the computer desktop and press "Win+R" on the keyboard.

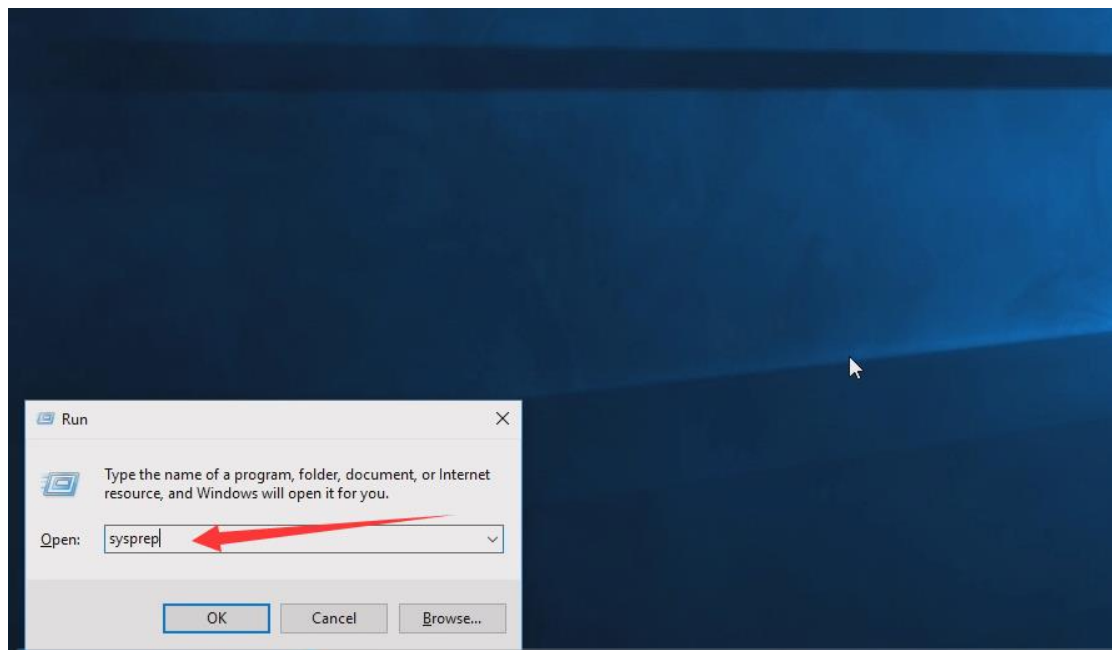

- 2、 Open the "Run" window, enter the "sysprep" command and press Enter to open the service window to see the C:WindowsSystem32sysprep folder, double-click sysprep.exe



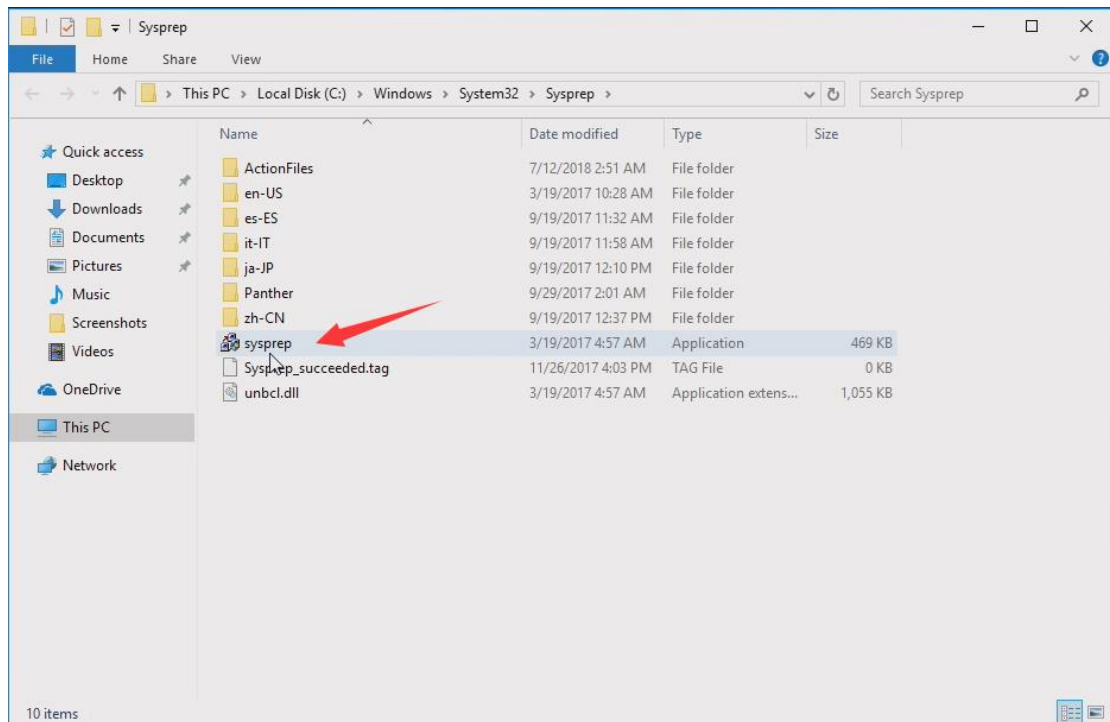

- 3、 In the window that appears, click the “System Cleanup Action” drop-down list box, select “Enter the system new experience (OOBE)” , select the “General” check box below, and then select “Shutdown option” or “Restart” . , click the "OK" button , Enter reset load , End!

